

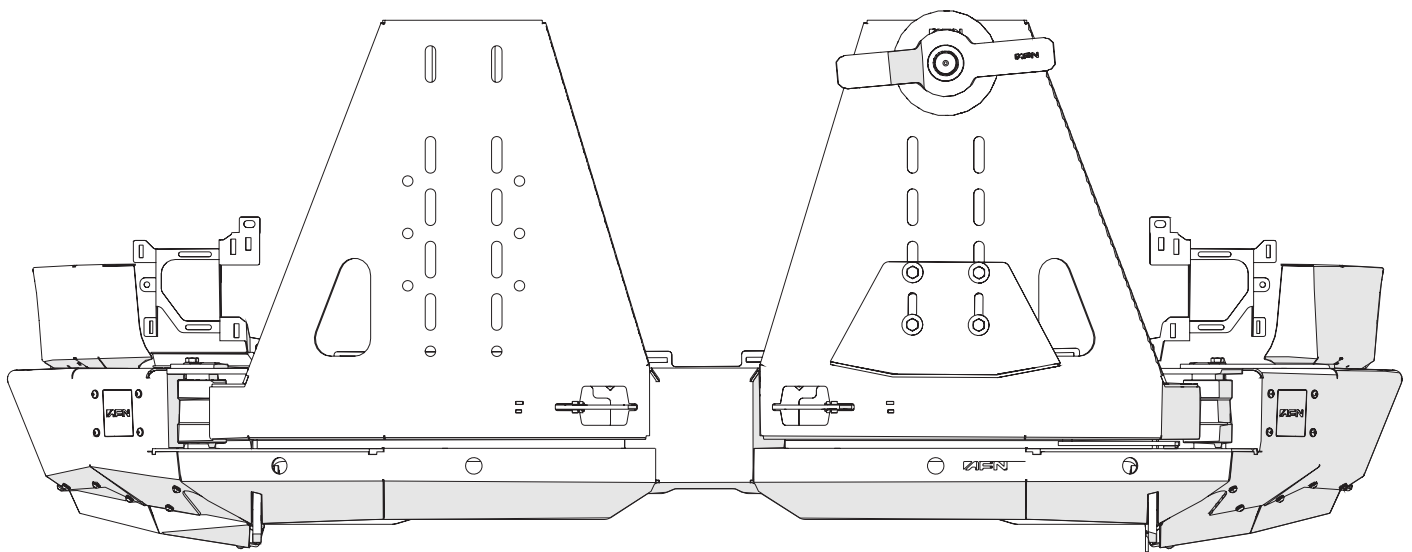

4 X 4 A C C E S S O R I E S

Fitting Instructions

Toyota LC 250



This manual contains the **Toyota LC 250** fitting instructions for:

Rear Bumper with wheel carrier & Modular Accessory Mount **REF: 48003032**

AFN 4x4 Accessories

Product:

Rear Bumper with wheel carrier & Modular Accessory Mount

Ref: **48003032**

Checklist	3
Products 48003032	
Fitting Instructions	4
Step 1	5
Step 2	6
Step 3	7
Step 4	8
Step 5	9
Step 6	10
Final Result	12

CHECKLIST

- In this section you have a checklist with all parts included for the installation of your AFN product
- This product should be installed as demonstrated in the product fitting instructions
- If verified that any component is damaged, please contact your nearest AFN distributor
- The specified parts will only fit in the models specified by AFN
- Do not modify any component of the product

This checklist is for product **48003032**

REF.: 48003032

NUMBER	DESCRIPTION	REFERENCE	QTY				
1	Rear Bumper	47003067	1x	29	Bolt M6x20	45000998	28x
2	Rear Bumper Arm (Left)	47003069	1x	30	Washer M6	45000979	28x
3	Rear Bumper Arm (Right)	47003068	1x	31	Cage Nut M6	45001012	44x
4	Adjustable Tire Cradle	46012620	1x	32	Bolt M6x20	45000043	20x
5	Bumper Extension / Filler Panel (Left)	47003072	1x	33	Washer M6 (Big)	45000044	4x
6	Bumper Extension / Filler Panel(Right)	47003071	1x	34	Bolt M10x25	45000015	4x
7	OEM Trim Bracket	47003070	1x	35	Washer M10	45000010	8x
8	OEM Light Bracket (Left)	46012622	1x	36	Nylock Nut M10	45000017	4x
9	OEM Light Bracket (Right)	46012621	1x	37	Gap Filler Trim (Left)	46012881	1x
10	Bumper Extension / Filler Panel Upper Mount (Left)	46012662	1x	38	Gap Filler Trim (Right)	46012882	1x
11	Bumper Extension / Filler Panel Upper Mount (Right)	46012661	1x	39	Bolt M8x20	45000058	8x
12	Bumper Extension Main Structure (Left)	46012618	1x	40	Nylock Nut M8	45000018	18x
13	Bumper Extension Main Structure (Right)	46012617	1x	41	Plastic Washer M6	45001802	20x
14	Bumper Extension Base Bracket (Left)	46012664	1x	42	Bolt M8x30	45000008	4x
15	Bumper Extension Base Bracket (Right)	46012663	1x	43	Washer M8	45000048	8x
16	Shim 3mm	46012686	2x	44	Washer M6 (Big)	45000500	4x
17	Spacer Plate	46012616	2x				
18	Wing (Left)	46012716	1x				
19	Wing (Right)	46012715	1x				
20	Wing Bracket (Left)	46012718	1x				
21	Wing Bracket (Right)	46012717	1x				
22	Radar Sensor Cover	46012714	2x				
23	Radar Mounting Bracket	46012612	2x				
24	Bolt M12x40	45000267	1x				
25	Washer M12 (Big)	45000036	4x				
26	Nut Plate M12	47002789	4x				
27	Bolt M8x40	45000091	6x				
28	Washer M8	45000011	22x				

FITTING INSTRUCTIONS

WARNING:

Before you begin installation, read all instructions thoroughly.
 Proper tools will improve the quality of installation and reduce the time required.

- This product should be installed as demonstrated in the *Product «Fitting Instructions»*;
- The specified parts, will only fit the models specified by **AFN**;
- Do not modify any component of the product;
- It is recommended that this product is installed by specialized and trained personnel;
- AFN doesn't take responsibility for changes made in the vehicle by its manufacturer;
- Work safely and use specialized tools at all times;
- **Always use protective gear.**



Size	Torque Nm	Torque lbft
M6	9Nm	7lbft
M8	22Nm	16lbft
M10	44Nm	32lbft
M12	77Nm	57lbft

Mouting Time

- 4 Hours
- 2 Persons (recommended)

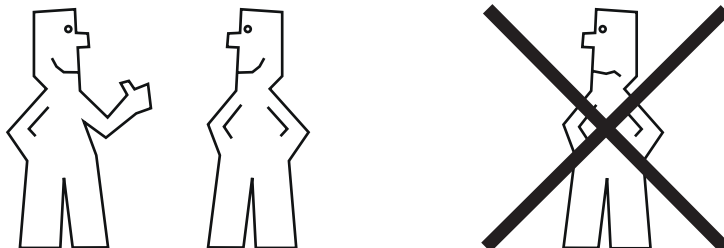

Tools Required

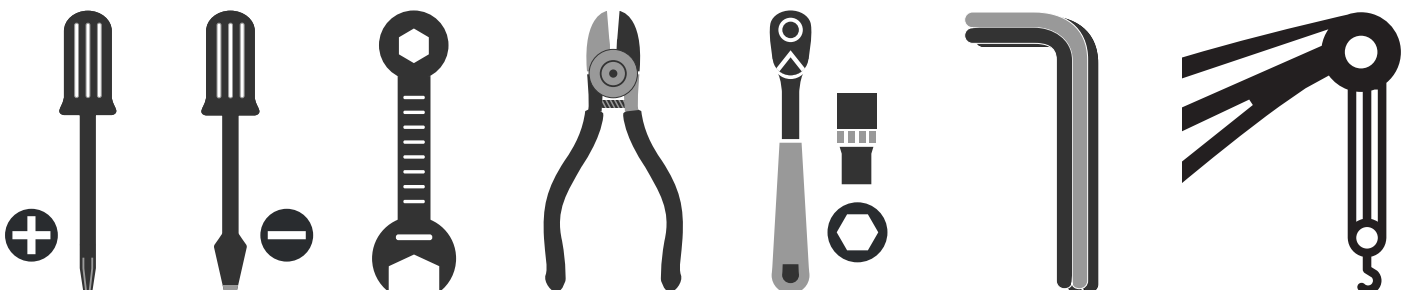

- Screwdriver star head
- Screwdriver flat head
- Wrench
- Wire cutter
- Ratchet wrench
- Allen wrench
- Crane

Step 1 - Bumper Preparation / Brackets

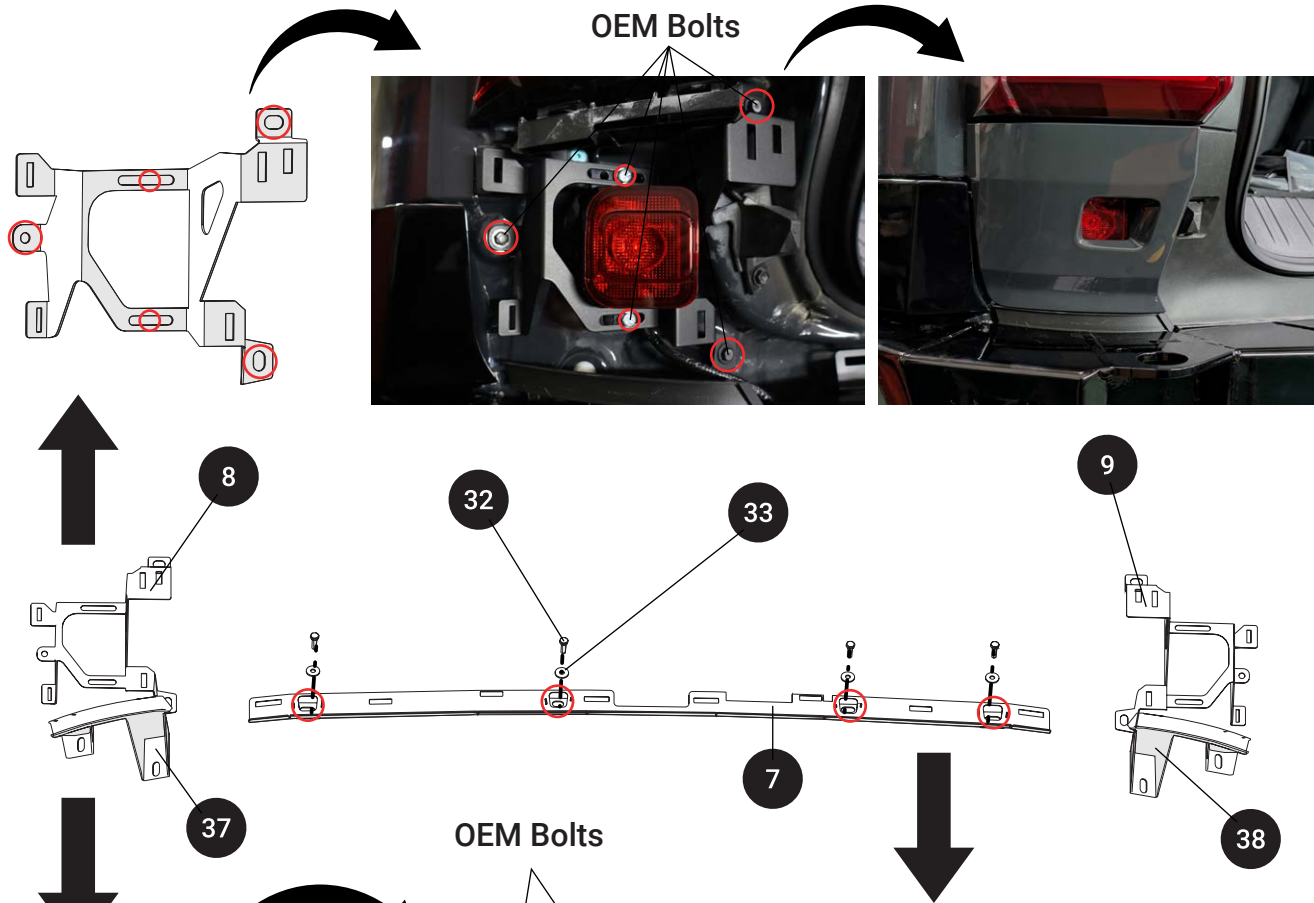

Parts Needed:

7

x1 47003070
OEM Trim Bracket

8

x1 46012622
OEM Light Bracket
(Left)

9

x1 46012621
OEM Light Bracket
(Right)

32

x4 45000043
Bolt M6x20

33

x4 45000044
Washer M6 (Big)

37

x1 46012881
Gap Filler Trim (Left)

38

x1 46012882
Gap Filler Trim (Right)

Step 2 - Bumper Preparation / Side Panels

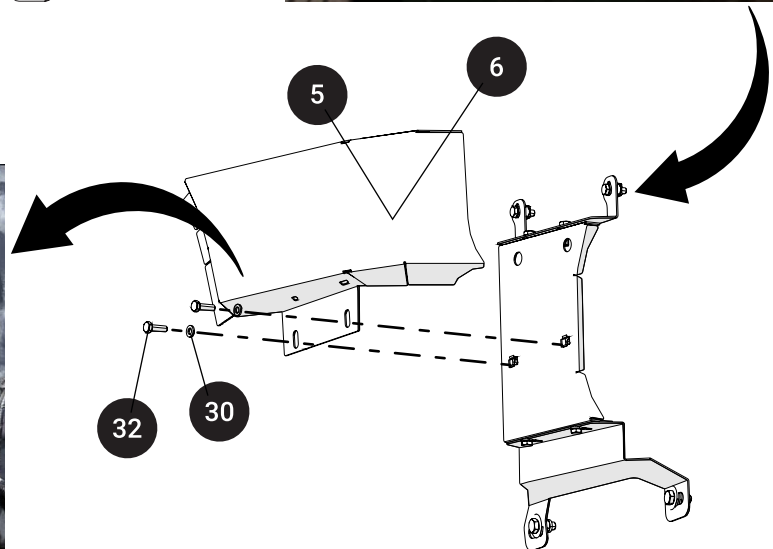
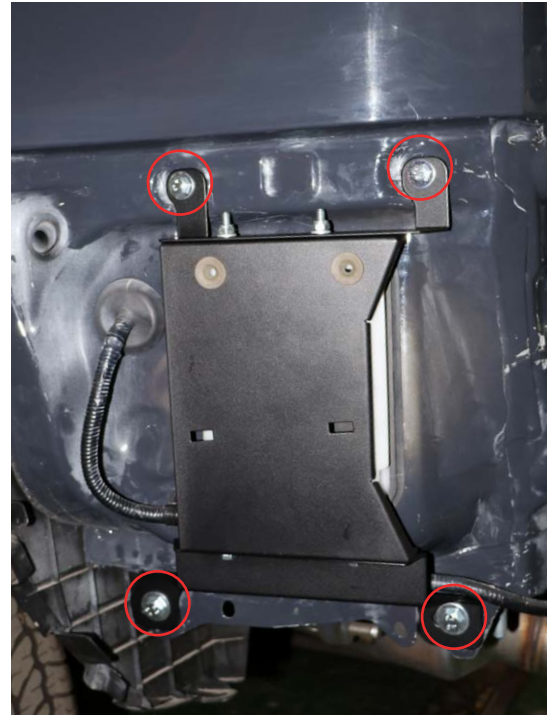
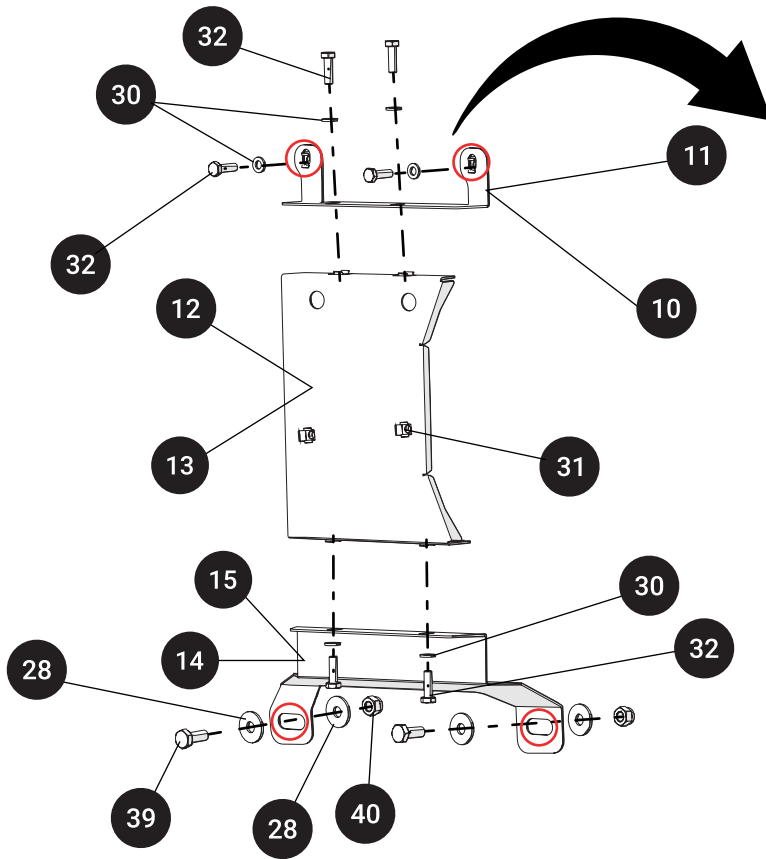

Parts Needed:

- | | | | | | |
|---|--|---|--|--|---|
| <p>5</p> <p>x1 47003072
Bumper Extension /
Filler Panel (Left)</p> | <p>6</p> <p>x1 47003017
Bumper Extension /
Filler Panel (Right)</p> | <p>10</p> <p>x1 46012662
Filler Panel Upper
Mount (Left)</p> | <p>11</p> <p>x1 46012661
Filler Panel Upper
Mount (Right)</p> | <p>12</p> <p>x1 46012618
Bumper Extension
Main Structure (Left)</p> | <p>13</p> <p>x1 46012617
Bumper Extension
Main Structure (R)</p> |
| <p>14</p> <p>x1 46012664
Bumper Extension
Base Bracket (Left)</p> | <p>15</p> <p>x1 46012663
Bumper Extension
Base Bracket (Right)</p> | <p>28</p> <p>x8 45000011
Washer M8 (Big)</p> | <p>30</p> <p>x16 45000979
Washer M6</p> | <p>31</p> <p>x16 45001012
Cage Nut M6</p> | <p>32</p> <p>x16 45000043
Bolt M6x20</p> |

39

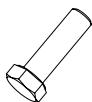

x4 45000058
Bolt M8x20

40

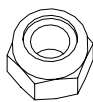

x4 45000018
Nylock Nut M8

Step 3 - Bumper Preparation / Sensors

Carefully remove the OEM parking sensor bezels from the original bumper. Re-install them into the corresponding ports on the AFN bumper using high-quality automotive double-sided tape, maintaining the original sequence and orientation.



OEM sensor holder
(bonded with double-sided tape)

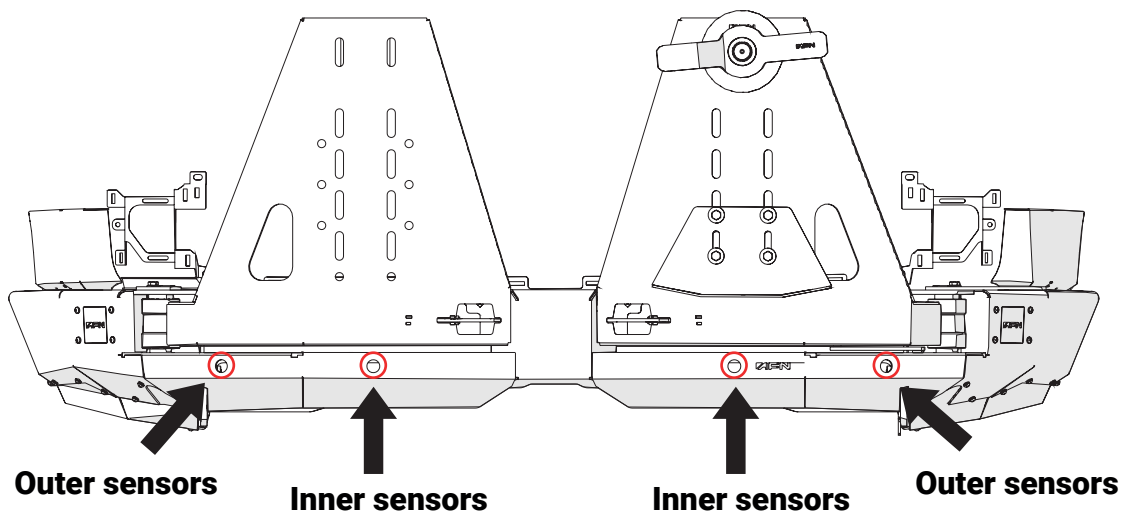

NOTE: Ensure both the holders and sensors maintain their original position and orientation. The outer sensors are angled, while the inner sensors are flat; swapping them will cause system interference.



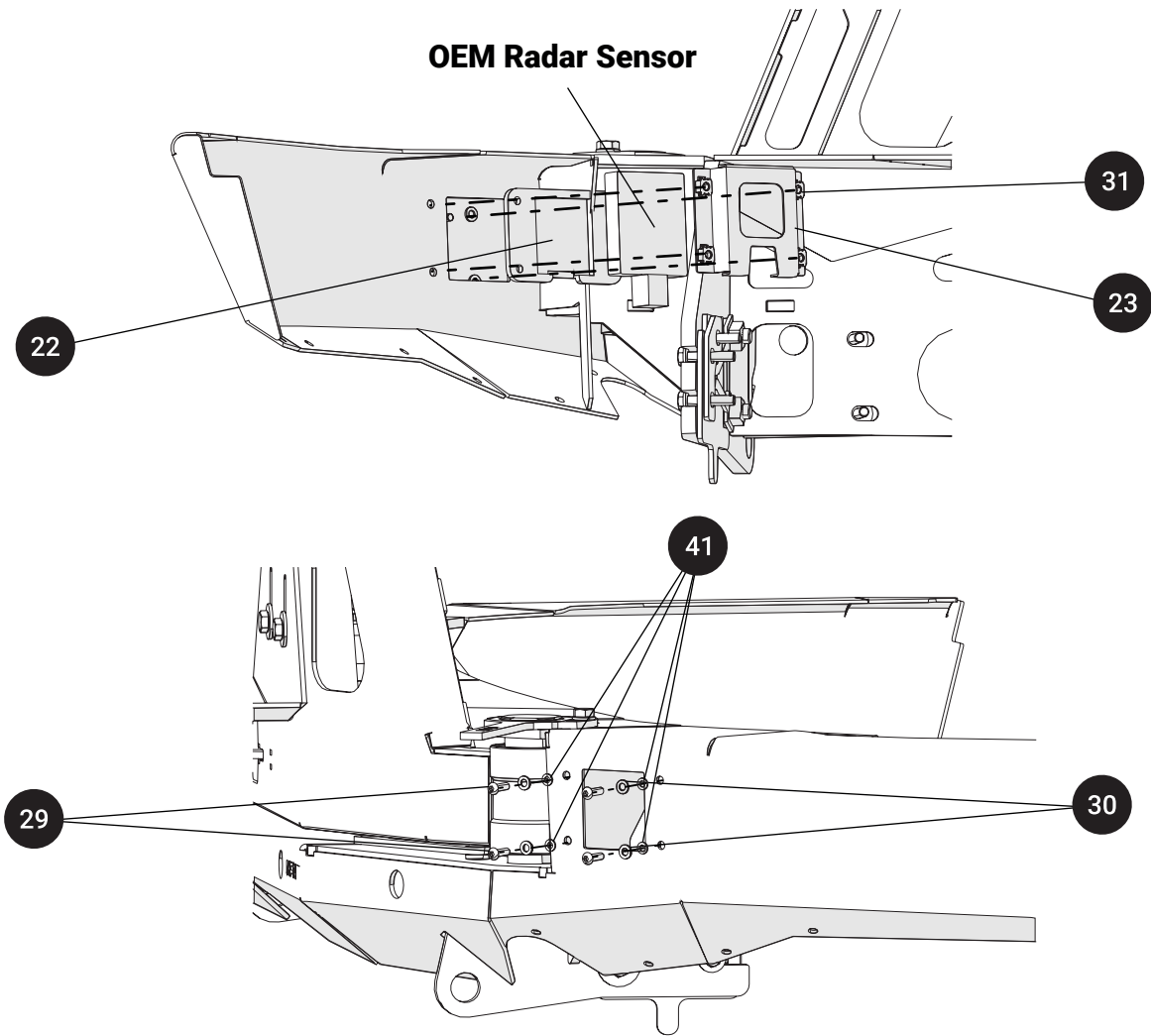

OEM parking sensor

Step 4 - Bumper Preparation / Radar

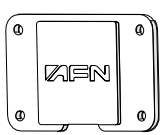
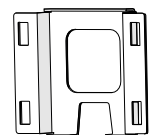
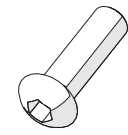

Parts Needed:

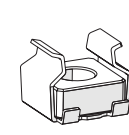
- | | | | | | |
|---|---|---|---|---|---|
| 22 | 23 | 29 | 30 | 41 | 31 |
|  |  |  |  |  |  |
| x1 46012714
Radial Sensor Cover | x1 46012612
Radial Mount Sensor | x8 45000998
Bolt M6x20 | x8 45000979
Washer M6 | x8 45001802
Plastic Washer M6 | x8 45001012
Cage Nut M6 |

Step 5 - Rear Bumper Assembly

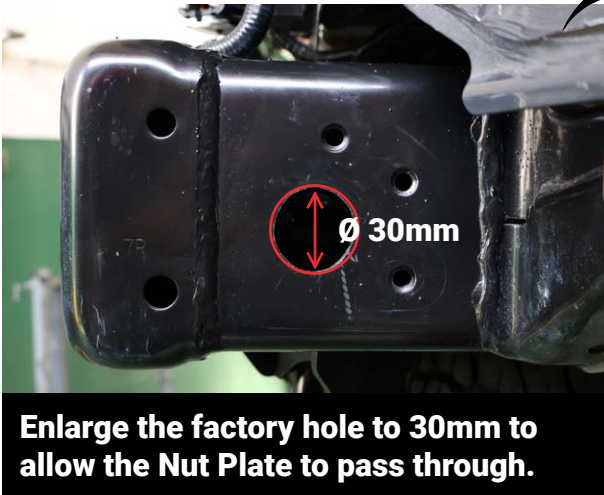

Enlarge the factory hole to 30mm to allow the Nut Plate to pass through.

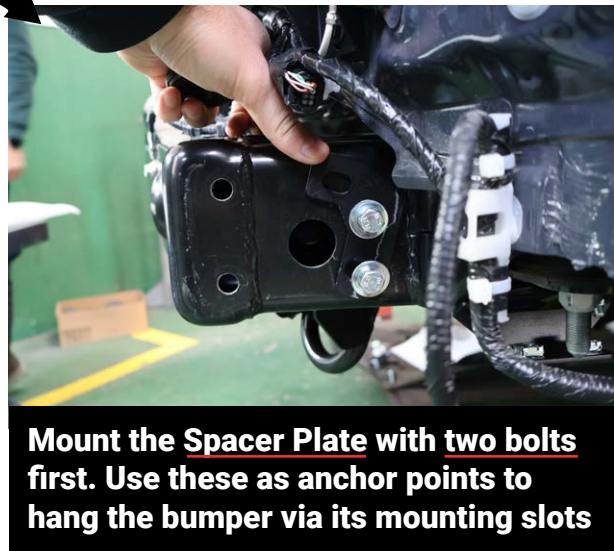

Mount the Spacer Plate with two bolts first. Use these as anchor points to hang the bumper via its mounting slots

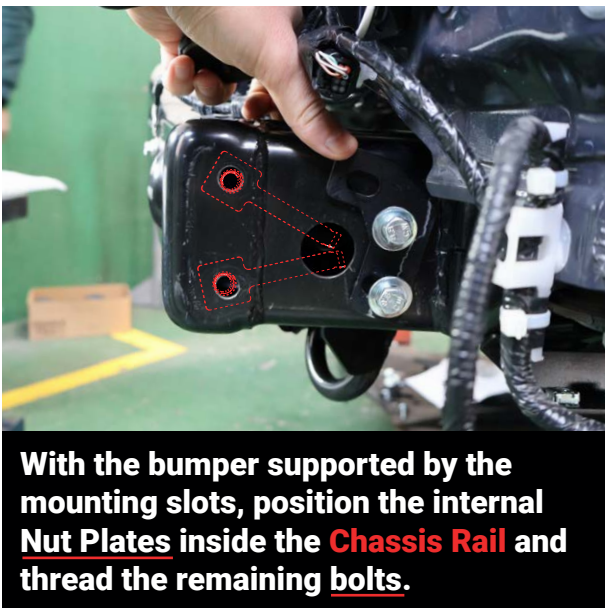

With the bumper supported by the mounting slots, position the internal Nut Plates inside the **Chassis Rail** and thread the remaining bolts.

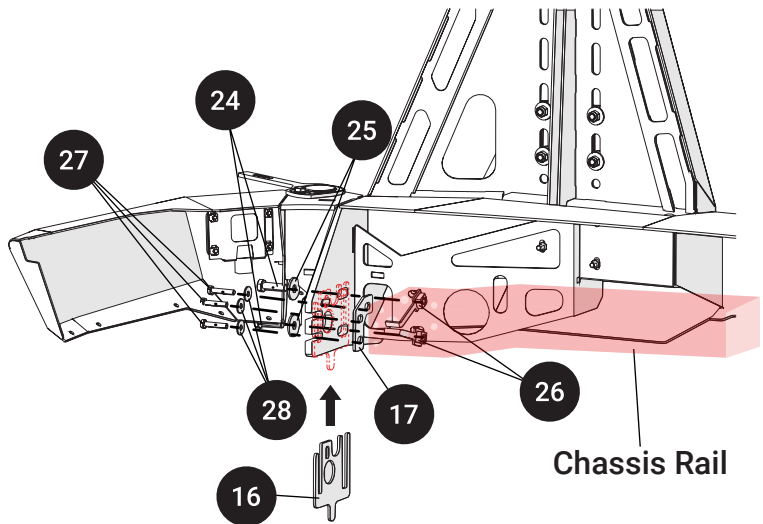

Chassis Rail

Parts Needed:

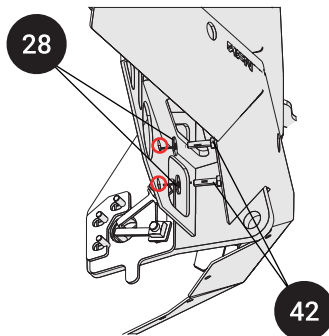
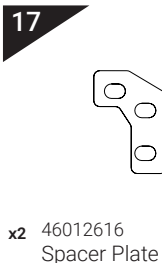
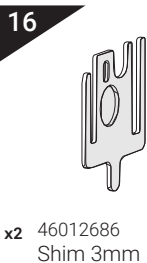

Install these bolts only after completing the previous steps and ensuring the bumper is correctly aligned.

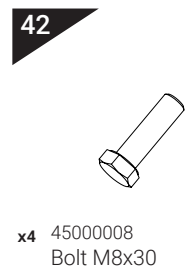
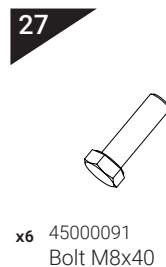
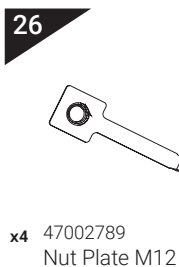
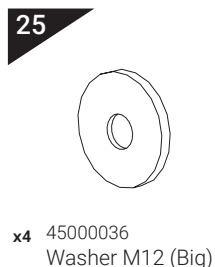
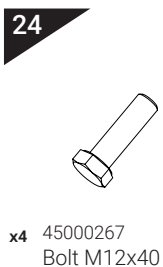

Step 6 - Wings

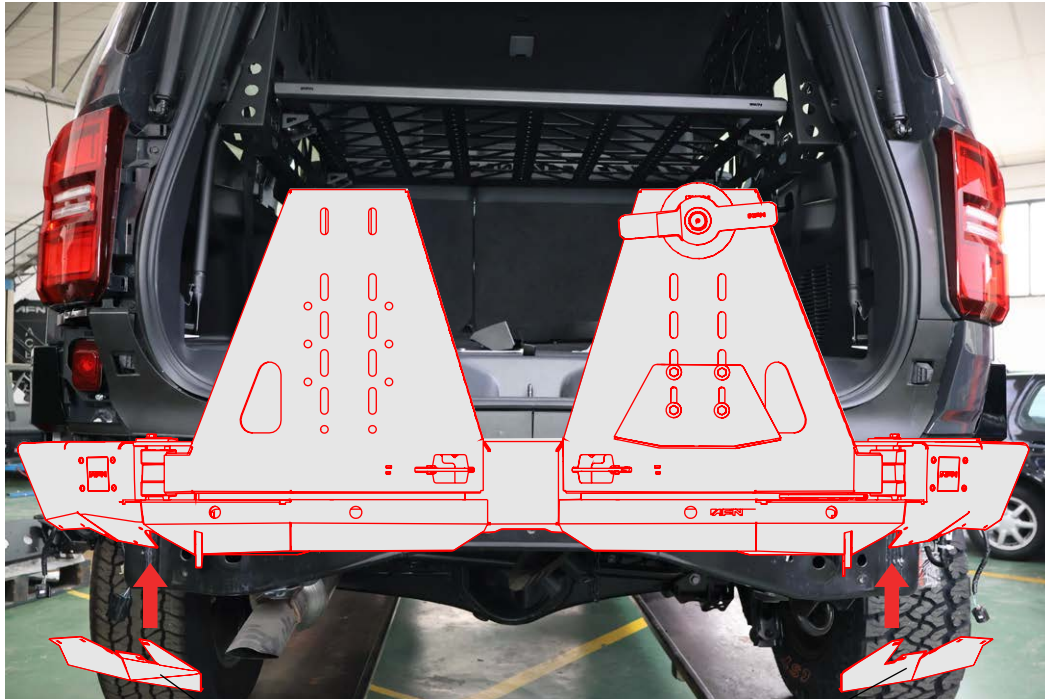

18

19

Exterior View

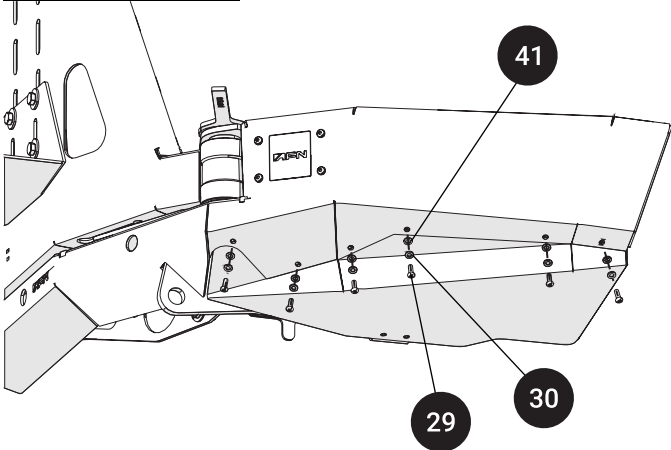

Interior View

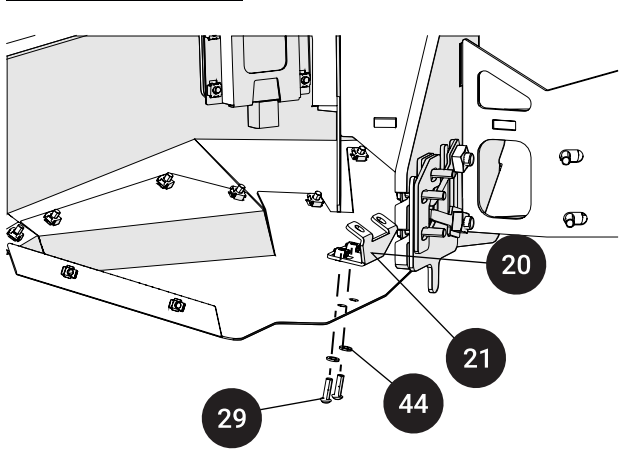

Parts Needed:

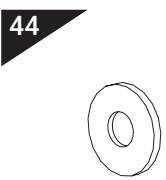
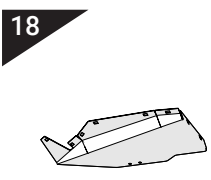

x1 46012716
Wing (Left)

x4 45000500
Washer M6 (Big)

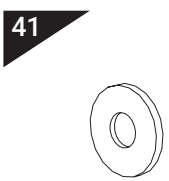
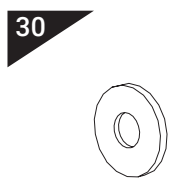
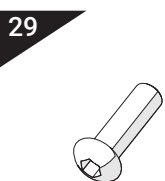
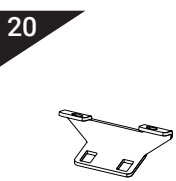
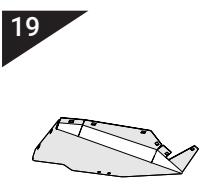

x1 46012715
Wing (Right)

x1 46012718
Wing Bracket (Left)

x1 46012717
Wing Bracket (Right)

x16 45000998
Bolt M6x20

x12 45000979
Washer M6

x12 45001802
Plastic Washer M6

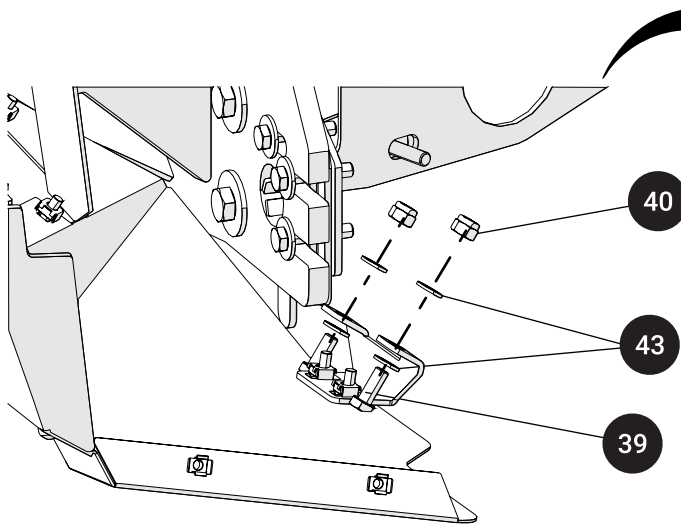

Chassis Rail



Align the liner to the bumper, mark, and trim along the line.

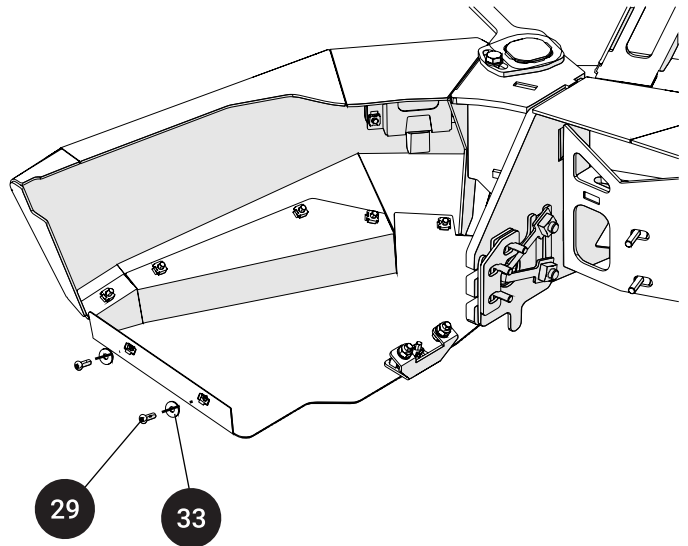

Parts Needed:

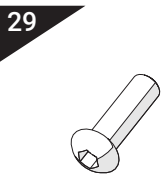

x4 45000998
Bolt M6x20

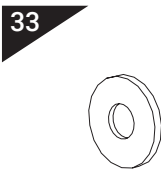

x4 45000044
Washer M6

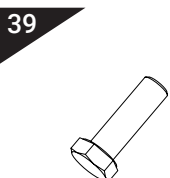

x4 45000058
M8x20

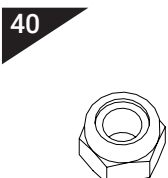

x4 45000018
Nylock Nut M8

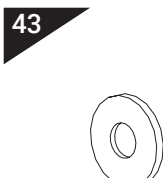

x8 45000048
Washer M8



Drill mounting holes through the liner.

Final Result

REF.: 48003032

